

Foldable Welding Booth

8x8 • 10x10 • 12x12

Feature

- Swinging door
- Viewing window
- Pre-assembled panels for easy onsite installation
- Easy to move and shape
- Foldable, for ease of storage

Add on options:

- Extra window(s)
- Interlock switch
- Double door kit

Part Numbers	Inner Dimensions	Outer Dimensions
BFS.M5P06.8x8	98" x 98"	99" x 99"
BFS.M5P06.10x10	120" x 120"	122" x 122"
BFS.M5P06.12x12	148 x 148"	150" x 150"

M5P06 Material

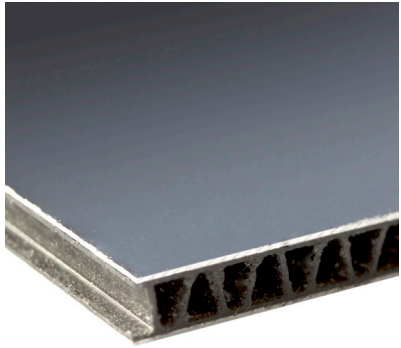

Color	Black
Weight	.78 lb./ft ²
Thickness	0.232 in. ± 1/32 in.
Description	Two layers of aluminum bonded with corrugated polyallomer core
Features	Maintenance-free, strong, lightweight. Doesn't swell, chip, corrode, flake, or peel

Irradiance Specifications	
Wavelength	Maximum Irradiance*
315 - 1050 nm	1,000 W/cm ²
>1050 - 1400 nm	2,500 W/cm ²
10600 nm	10,000 W/cm ²

*Tested for 100 seconds at a 1mm beam diameter

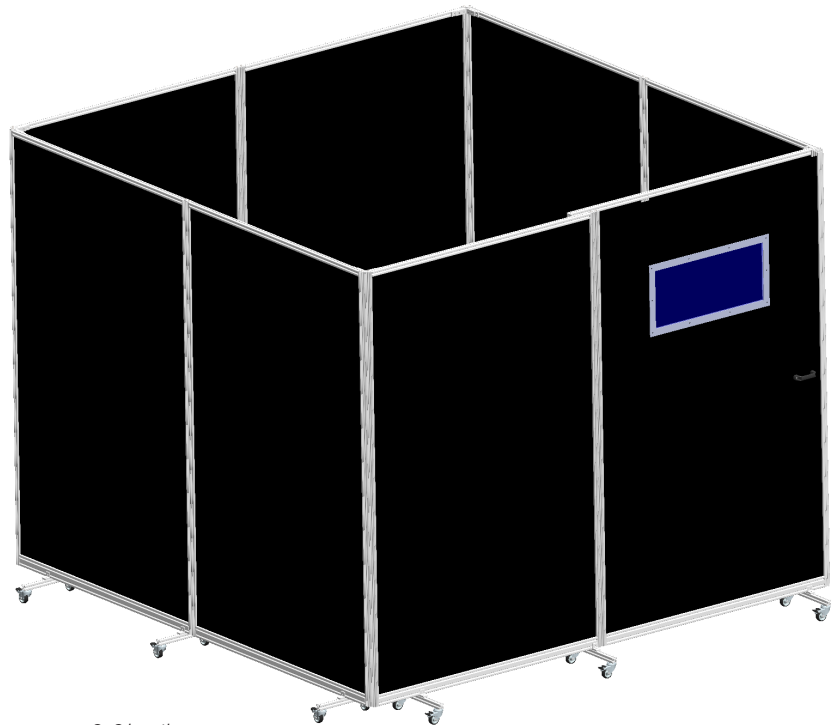

8x8 booth

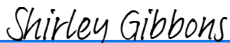

 Shirley Gibbons (Apr 10, 2024 12:56 CDT)
 Authorized Laservision Signature

Three sizes:

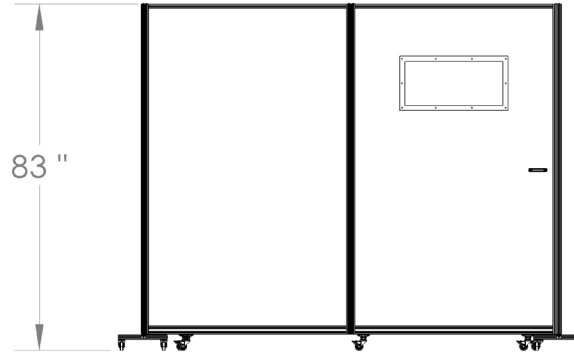
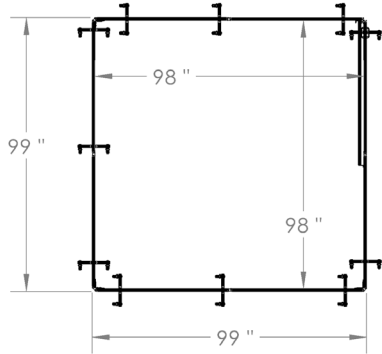
8x8

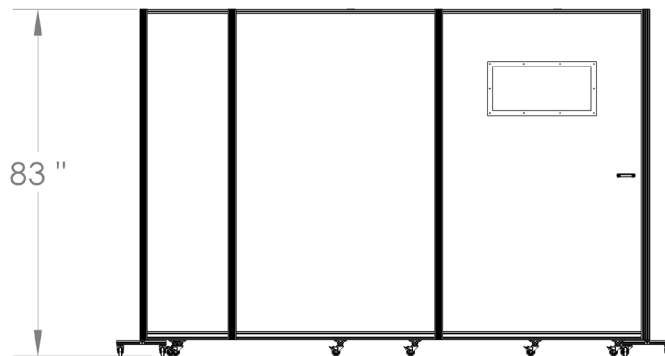
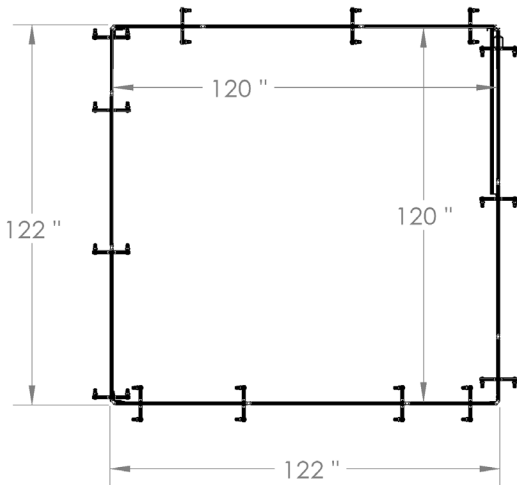

10x10



12x12

